



837 Manchester Road

Haslingden | BB4 6LB

837 Manchester Road

Haslingden | BB4 6LB



Overview

- Character Cottage
- With Fantastic Potential
- Two Double Bedrooms
- Fitted Kitchen
- Basement Level Storage
- South-West Facing Rear Yard
- Pleasant Views Across The Valley
- Popular Yet Convenient Location
- Ideal For First Time Buyers/Investors
- Convenient Location
- No Chain



Two Bedroom Character Cottage Situated In A Popular Yet Convenient Location

Offering excellent potential, this character cottage is situated in a popular yet convenient location, with easy access to excellent local amenities, a nearby train station, quick access to Rawtenstall and Ramsbottom town centres, as well as the motorway network. The property is also on the doorstep of beautiful open countryside.



Internally, the spacious property offers ideal first-time buyer living accommodation comprising of a hall, large lounge, stylish fitted kitchen, two double bedrooms, three-piece bathroom, and basement level storage/utility room. The property also benefits from having gas central heating and upvc double glazing throughout.



Externally, the property benefits from having access to a South-West facing rear yard with seating area and storage.

**NO CHAIN - IDEAL FOR
FIRST-TIME
BUYERS/INVESTORS!**

Basement

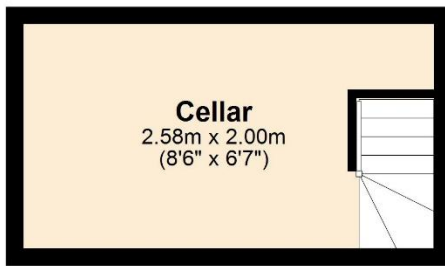

Ground Floor

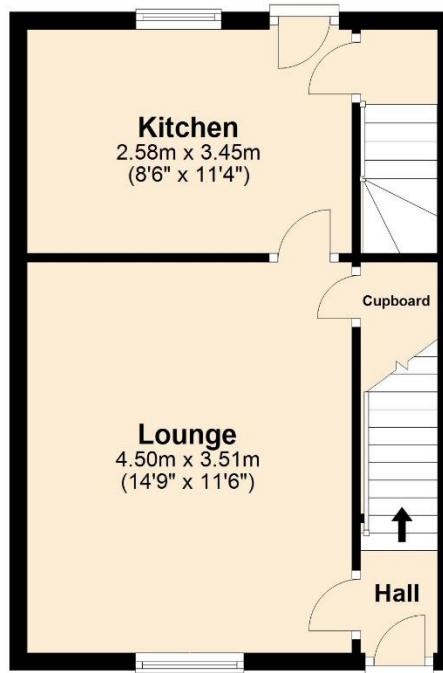

First Floor

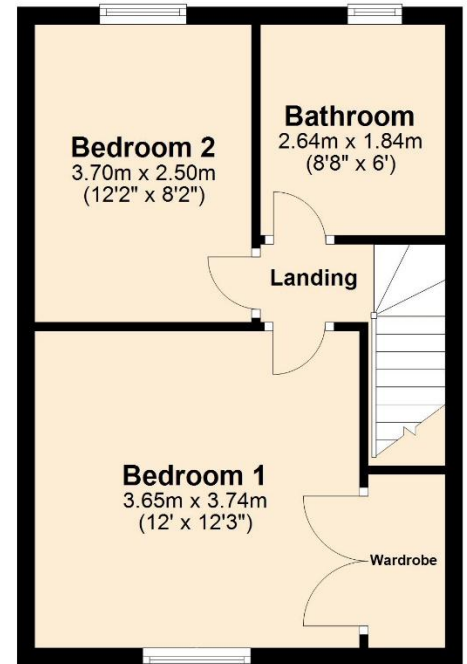

4 Smith Street, Rochdale
Lancashire, OL16 1TU

Tel: 01706 356633

Email: enquiries@reside.agency

www.reside.agency



rightmove

Zoopla

PrimeLocation.com

"Once you find the property you want to buy, you will need to carry out more investigations into the property than it is practical or reasonable for an estate agent to do when preparing sales particulars. For example, we have not carried out any kind of survey of the property to look for structural defects and would advise any homebuyer to obtain a surveyor's report before exchanging contracts. If you do not have your own surveyor, we would be pleased to recommend one. We have not checked whether any equipment in the property (such as central heating) is in working order and would advise homebuyers to check this. You should also instruct a solicitor to investigate all legal matters relating to the property (e.g. title, planning permission etc) as these are specialist matters in which estate agents are not qualified. Your solicitor will also agree with the seller what items (e.g. carpets, curtains etc) will be included in the sale".